

## PW 0

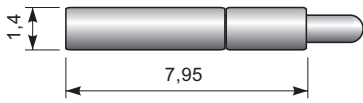

### TECHNICAL SPECIFICATIONS

<b>Mechanical Life:</b>	1 M
<b>Current Rating:</b>	3 Amp
<b>Plunger Material:</b>	Becu-Gold Plated
<b>Barrel Material:</b>	Brass-Gold Plated
<b>Spring Force:</b>	On Request
<b>Destination:</b>	+ receptacles

## PW 1

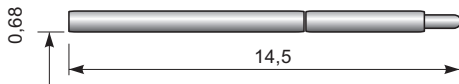

### TECHNICAL SPECIFICATIONS

<b>Mechanical Life:</b>	200 K
<b>Current Rating:</b>	3 Amp
<b>Plunger Material:</b>	Becu-Gold Plated
<b>Barrel Material:</b>	Brass-Gold Plated
<b>Spring Force:</b>	On Request
<b>Destination:</b>	+ receptacles

## PW 2

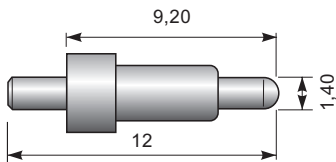

### TECHNICAL SPECIFICATIONS

<b>Mechanical Life:</b>	200 K
<b>Current Rating:</b>	5 Amp
<b>Plunger Material:</b>	Becu-Gold Plated
<b>Barrel Material:</b>	Brass-Gold Plated
<b>Spring Force:</b>	On Request
<b>Destination:</b>	solded on PCB

## PW 3

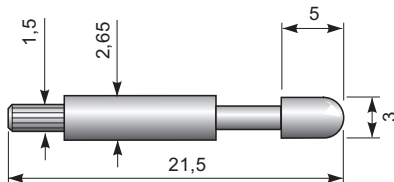

### TECHNICAL SPECIFICATIONS

<b>Mechanical Life:</b>	400/800 K
<b>Current Rating:</b>	3 Amp
<b>Plunger Material:</b>	Nickel or Gold Plated
<b>Barrel Material:</b>	Brass-Gold Plated
<b>Spring Force:</b>	On Request
<b>Destination:</b>	solded on PCB

## PW 4

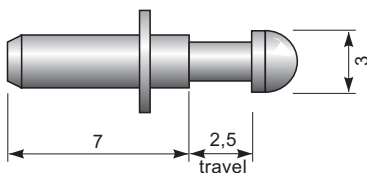

### TECHNICAL SPECIFICATIONS

<b>Mechanical Life:</b>	500 K
<b>Current Rating:</b>	3 Amp
<b>Plunger Material:</b>	Nickel or Gold Plated
<b>Barrel Material:</b>	Brass-Gold Plated
<b>Spring Force:</b>	On Request
<b>Destination:</b>	solded on PCB

## PW 5

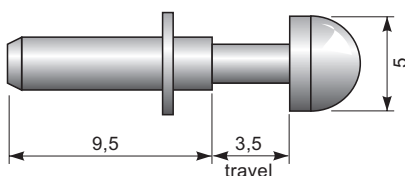

### TECHNICAL SPECIFICATIONS

<b>Mechanical Life:</b>	500 K
<b>Current Rating:</b>	3 Amp
<b>Plunger Material:</b>	Nickel or Gold Plated
<b>Barrel Material:</b>	Brass-Gold Plated
<b>Spring Force:</b>	On Request
<b>Destination:</b>	Solded on PCB